

Instructions for use

1-piece soft convex high output

1 PREPARATION

**1a**

Ensure the area around the stoma is clean and dry. If the pouch is pre-cut, please proceed to **step 2**.

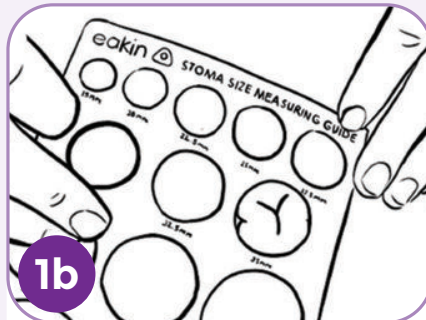
**1b**

If the pouch needs to be cut to size, use the enclosed measuring guide to measure the size and shape of the stoma.

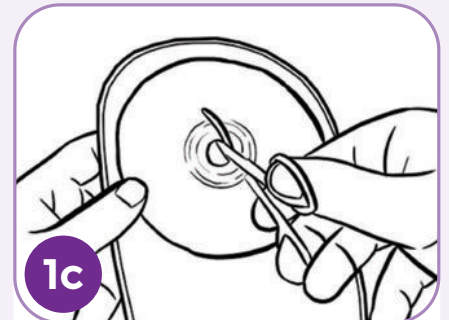
**1c**

Using the cutting guide on the baseplate, cut a hole to fit the exact pre-measured size and shape of the stoma using curved scissors - taking care not to cut through the pouch film on the other side.

2 APPLICATION

**2a**

Peel the protective film off the baseplate.

**2b**

Align the centre hole on the baseplate with your stoma. Press gently against your skin, starting just below your stoma, smoothing upwards and outwards.

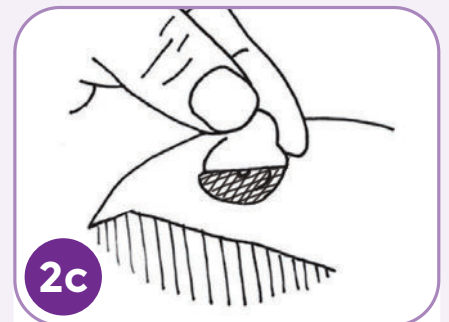
**2c**

A filter cover may be used when bathing or to prevent 'pancaking.' Apply directly over the filter, which is seen as a dark circle.

3 EMPTYING

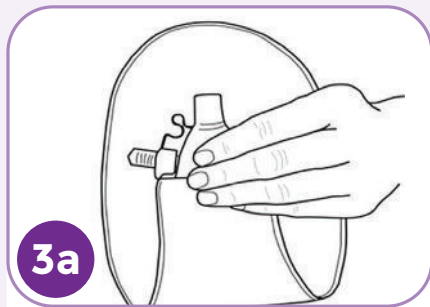

3a

Lift the bung up, remove the stopper and fasten at the side.

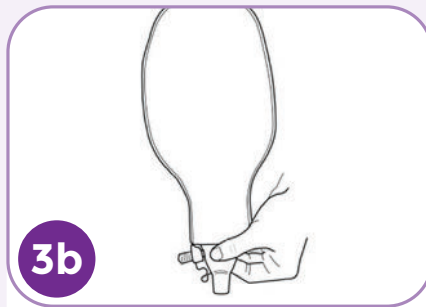

3b

Point the bung down and empty into a toilet. To control the flow, squeeze the area above the bung.

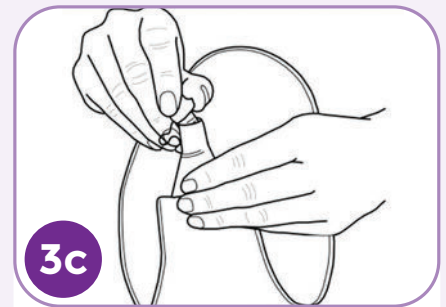

3c

To close, re-insert the stopper into the bung.

4 REMOVAL



4a

Gently remove the pouch by peeling the baseplate downwards and away from the skin. Apply light pressure to your skin with your free hand to aid removal.

The use of a medical adhesive remover product is highly recommended.

5 DISPOSAL



5a

Place used products into a waste bag and waste bin.

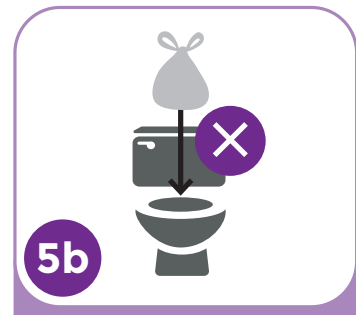

5b

Do not flush the product down the toilet. Dispose of waste products in accordance with local guidelines.

HIGH FLOW COLLECTOR BAG

For output that is very loose and high volume, the pouch can be connected to the 2-litre B Braun high flow collector bag (039901) to help with overnight collection.



1

Empty the pouch first. Secure the bottom of the high flow collector by pushing green plug into the green outlet firmly.



2

Uncap the pouch and insert the end of the pouch bung firmly into the end of the wide bore tubing.

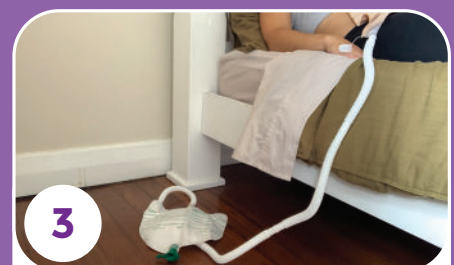

3

Place high flow collector on the ground (in a container if desired) to allow gravity flow of output into the 2-litre bag. The contents of the bag can be emptied directly into the toilet and the bag rinsed out as needed.



OMNIGON

AU 1800 819 274 info@omnigon.com.au
NZ 0800 440 027 www.omnigon.com.au