

Qufora[®] IrriSedo Bed

Complete, controlled and hygienic irrigation



Bowel irrigation. User Guide.

 **Qufora[®]**
Your life. Our inspiration.

Welcome to using Qufora IrriSedo

In this booklet we will give you advice on how to use your Qufora® IrriSedo Bed and support you through your journey using bowel irrigation.

It is important to keep in touch with your healthcare professional, as they can give you the individual advice and support you need. Use this booklet as a supplementary guide and reference.

Guide and common questions

Your healthcare professional will explain how to use your Qufora IrriSedo Bed and show you how it works in practice. As a reminder we also have a guide in this booklet, plus we answer some common questions.



What is bowel irrigation?

Bowel irrigation (sometimes called anal irrigation or trans-anal irrigation) has been practiced for many hundreds of years. Over recent years it has been more widely used as a bowel management solution.

It simply involves instilling lukewarm tap water into the rectum via the anus and then allowing the water to be expelled, thus emptying the colon.

Studies have shown that regular rectal irrigation can be an effective solution to prevent faecal incontinence and constipation. It can also reduce the amount of time spent on bowel management.

Bowel irrigation provides a reliable bowel management option, it is easy, quick, effective and hygienic to use, allowing you to live life to the full and not worry about your bowels.

Advantages using bowel irrigation

- Helps achieve bowel continence
- Helps prevent constipation and related problems
- May reduce time spent on the toilet
- Reduces the risk of urinary tract infection
- May reduce the use of and need for laxatives

Starting your journey using Qufora IrriSedo

Many people find irrigation easy to do right from the start and their bowel symptoms are relieved very quickly. For some others this may take a little longer. Learning something new can take a bit of practice but the results will be worthwhile if you persevere.

Sometimes the bowel gets into a routine easily but for others it may require some modification e.g. the amount of water instilled, your bowel medication etc. That's why many healthcare professionals advise irrigating every day for at least the first three months.

Don't give up if the results are not what you would like immediately. It can take time. The aim is for you to eventually have the bowel routine that fits in with you, so you don't have to worry about your bowel and you can get on with your life. Your healthcare professional will show you the system and then get you to practice with it before you do it on your own.

Understanding your Qufora IrriSedo Bed

When you first start irrigating it's a good idea to put the product together and fill it with water a few times. This will help you become more familiar with it when you actually use it to irrigate your bowel.

Qufora IrriSedo Bed





Important information

Amount of water for irrigation

Only use the amount you have been advised. Generally this is around 500ml, but no more than 1000ml. The aim is to use the least amount of water to give you the best result.

Every day

You should irrigate every day for the first 3 months (unless your healthcare professional asks you to do differently) this will help to clear the bowel and get you into a routine.

Don't stop your medication

Don't stop or reduce your bowel medication unless your healthcare professional has asked you to. This is still necessary until your bowel gets used to irrigation. Then your healthcare professional will advise you to reduce or stop it.

Drinking water

Always make sure to drink the correct amount of water (adults approx. 1-2 litres per day). If your water intake is too low, this may result in the irrigation water being retained and absorbed by the bowel.

Obtaining further supplies

To ensure you have enough supplies, order regularly and in plenty of time.

Getting the right routine

So many people's lives have been improved using Qufora. For some people this happens very quickly, for others it takes a while longer, but the important thing is to take time to get the right routine for you.

Remember - don't give up

How to use Qufora IrriSedo Bed

Read the instructions for use and contact your healthcare professional if you need any further advice.

Before use

Make sure you have your system ready and some warm tap water.

After use

The catheter is single use. Dispose of catheter and collecting bag in clinical waste or according to local policy.

Rinse before storing

Empty water from the system, if required clean the outside of the system with luke warm water and mild soap, rinse it and hang it to dry.



Only use irrigation as agreed with a qualified healthcare professional and after undergoing thorough training.

The system components

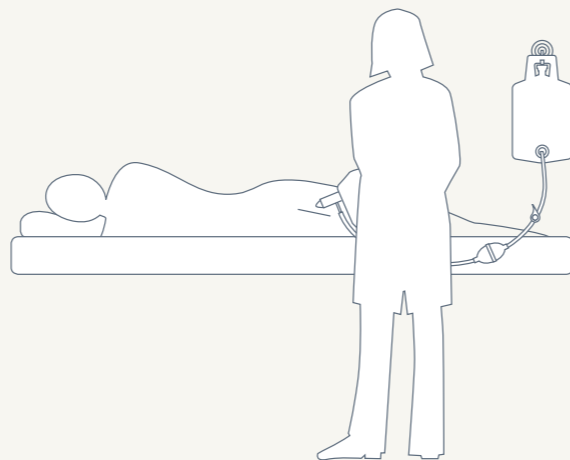
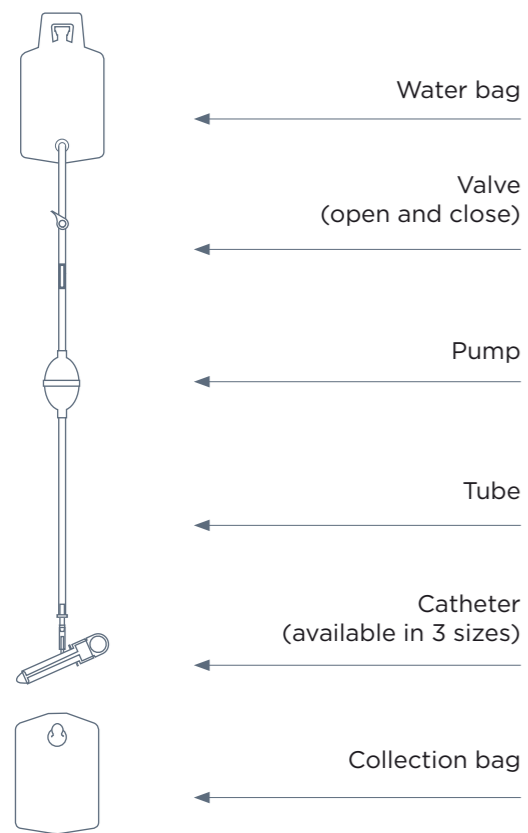

Irrigation process

1



Fill the water bag with approx. 100ml more water than you need to irrigate. Hang water bag at shoulder height or above.

2

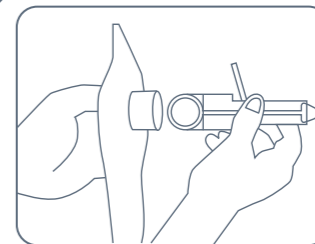

Fit the collection bag to the catheter with the insertion guide in the catheter.

3

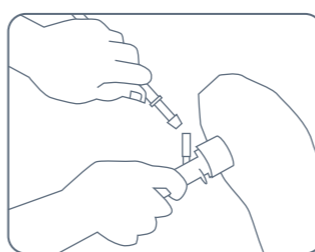

Connect the tube to the rectal catheter.

4

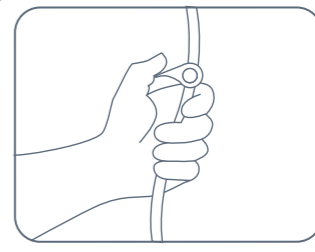

Open the valve and pump water to fill the tubing. Close the valve again.



5

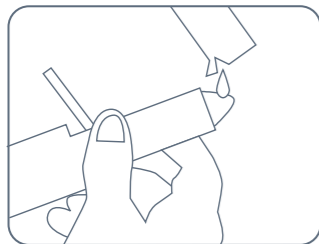

Lubricate the catheter with Qufora® lubricating gel.

6



With a firm grip, hold on to the ring of the insertion guide (inside the bag) and the bag at the 500ml mark.

9

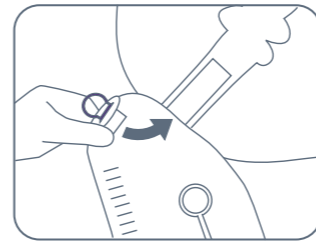

Insert the collection bag plug into the end of the catheter to seal it. Continue to support the catheter.

10

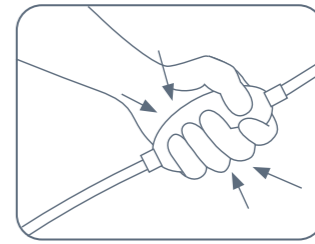

Open the valve and use the pump to instill water into the rectum.

7

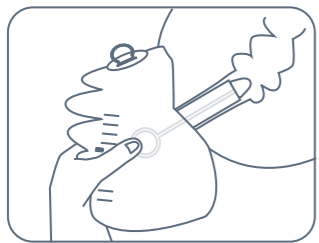

Position the patient on their left side, towards the edge of the bed. Carefully insert the catheter into the rectum with the insertion guide.

8



With the catheter in the rectum pull out the insertion guide and let it drop inside the collection bag.

11

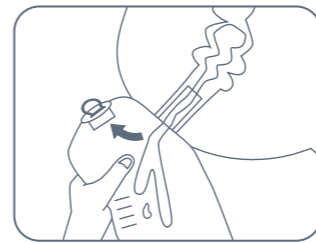

Pull the plug out of the rectal catheter to allow the stool and residual water to flow into the collection bag.

12



Steps 9-11 should be repeated until the desired amount of water has been instilled and removed. Remove the catheter carefully. Safely dispose of catheter and collection bag in clinical waste or according to local policy.

Cleaning and storage: Empty water from the system, if required clean the outside of the system with luke warm water and mild soap, rinse it and hang it to dry.

Common questions

Always contact your healthcare professional for medical advice but some common questions are answered below.

What if I have any pain or bleeding when I insert the cone?

Minor bleeding can be due to trauma from cone insertion. Remember to wet the cone to activate the lubricating gel and insert the cone slowly and gently into the rectum. If minor bleeding or pain persists contact your healthcare professional. If you have excessive pain or bleeding seek immediate medical advice.

What if the water leaks out as I'm pumping it into the bowel?

Make sure you have inserted the cone tip high enough into the rectum and support it firmly with your hand.

What if no water comes out after I have removed the cone?

Wait for a few more minutes, you can try coughing and massaging your abdomen, this can help to start the bowel moving. Sometimes you may be dehydrated and the water absorbs into the bowel lining. If this persists contact your healthcare professional.

What if the water is not safe for drinking?

Use bottled water or cooled boiled water for irrigation too.

Common questions

How many boxes of Qufora IrriSedo Bed do I need each month?

Daily irrigation: Six boxes of 5 irrigation set per month. Alternate day irrigation: Three boxes of 5 irrigation set per month.

Where do I get my supplies?

You get a prescription from your GP or prescribing nurse. Then you can get products from your chemist.

What if I still have stool coming out after my irrigation session is finished?

This may be something that happens in the early stages of irrigation when the bowel is quite full. It may be resolved after using irrigation for a while.

“

The help of your team has been invaluable.
It is a joy to pick up the phone to them.
They always give their name and then listen
carefully...

How to obtain your product supplies

Order further supplies

Ordering supplies regularly and in plenty of time ensures you have enough products as needed. Ordering details are at the back of this booklet.



1800 819 274



info@omnigon.com.au



www.omnigon.com.au



facebook.com/qufora



www.qufora.com

Ordering information

Order code	Product	Contents
53001-111	Demo set	1 x water bag with pump, 1 x collection bag, 1 x gel sachet, 1 x hook, 3 x single use rectal catheters (Ø12mm, Ø21mm, Ø30m)
53201-015	Irrigation set - Ø12mm	1 x water bag with pump, 15 x rectal catheters Ø12mm, 15 x collection bags
53001-015	Irrigation set - Ø21mm	1 x water bag with pump, 15 x rectal catheters Ø21mm, 15 x collection bags
53101-015	Irrigation set - Ø30mm	1 x water bag with pump, 15 x rectal catheters Ø30mm, 15 x collection bags



Distributed by:

Omnigon

Level 2

582 Swan Street

Burnley VIC 3121

Australia

Tel

1800 819 274

Email

info@omnigon.com.au

Web

www.omnigon.com.au

Qufora[®] is a registered trademark of Qufora A/S. ©08/2024.
All rights reserved Qufora A/S, 3450 Allerød, Denmark.
The information provided on this user guide should not be used for
diagnosing or treating a health problem or disease. It is not medical
advice and is not intended to be a substitute for the advice of your
personal physician or other healthcare provider.