







# How do I cut my 2P (two-piece) base to the correct size?

## YOU WILL NEED



## HANDY TIPS

-  You'll need to check your stoma size frequently after surgery, and less frequently after the first few weeks.
-  You can pre-cut a few of your supplies when you receive them, so you always have some ready to go.
-  If you are flying, pre-cut some bases, as you can't take scissors onto a plane.
-  Curved scissors are best. These are available through your stoma association or product company.

\*Your stoma measuring guide is found in the box with your product.

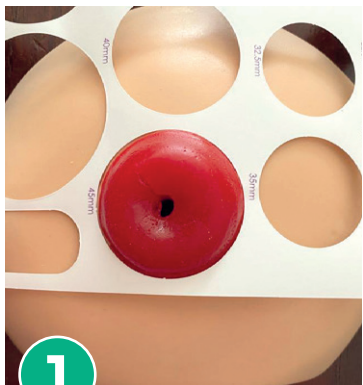

1

Using the guide, check the size of your stoma in mm, making sure there is 1-2mm clearance at the edge.

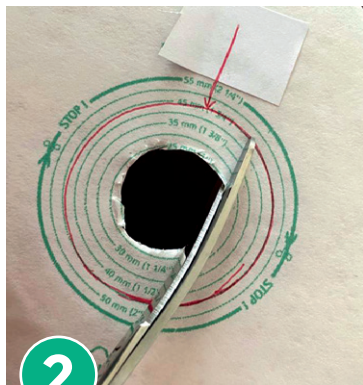

2

Identify the correct cutting line size on the back of your base. Sometimes it can be easier to mark the line in a different colour.

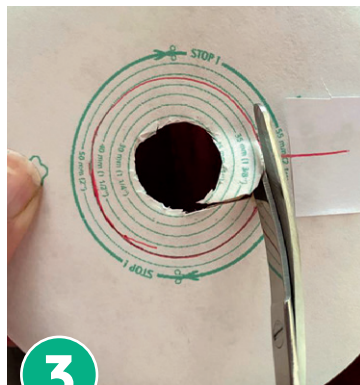

3

Using your curved scissors, cut along the correct line.



4

Try and ensure an even cut. Cut the whole way around.



5

When you are ready to apply your new base, remove the backing and press on to the clean, dry skin.